



'An Open Sketchbook', Liz Myhill and Alison Price, photography by Alexander Hoyles

Perth Creative Exchange

Stormont Street

Perth

PH1 5NW

Gallery Pack



An Introduction to Perth Creative Exchange

Perth Creative Exchange is a £4.5m partnership project between Wasps and Perth and Kinross Council which transformed the former St John's School building to create Perth's first 'creative hub' - an inspiring home for artists, makers, creative industry professionals and the general public. The building provides vibrant and connected spaces over three floors and includes 26 studios, 12 workspaces and The Famous Grouse Ideas Centre, a creative business incubation space.

The Perth Creative Exchange exhibition space is known as The Gannochy Project Space. This space exists to support both Wasps tenants and the wider creative community in Perthshire by providing high quality exhibition space, and an inspirational programme to develop creative practice and to provide links with the wider creative communities in Scotland and beyond.

This space is open Monday to Friday via the main reception, situated on the ground floor, and is used for exhibitions and events. Readily accessible to all, the gallery has been flexibly designed to host all kinds of commercial and non-commercial practice and can be used for exhibitions, film screenings, forums, performances and numerous other events.

On occasion the space can be expanded to include the general reception wall space but this must be requested in advance in writing.

Gallery Images



Gallery Features

The Gannochy Project Space is a large 'white cube' gallery space. There is a fixed lighting rig composed of 3 continuous strip lights that are dimmable. Additionally, there is a number of cold white LED spotlights that are moveable on a track around the space, these are also dimmable.

The gallery space is accessed through a moveable wall that is lockable, this wall concertinas to the right-hand by the window when exhibitions are open.

Dimensions

Gannochy Project Space – (L) x (W) = 34 m²

The Café Space – (L) x (W) = 70 m²

Capacity

Gannochy Project Space – 23 people

The Café Space – 47 people

Wall Features

The space features two windows. These can be used to display works, though please consider that the first window to the right of the door can be used to display exhibition vinyl.

The ceiling is white plaster board and whilst items may possibly be installed here, we advise artists to undertake a site visit prior to planning any vertical fixed installations. This is also subject to a thorough risk assessment which will be reviewed by the Wasps Property Team.

Walls and Doors

Internal walls - White painted plasterboard, with lower wood paneling painted white.

Tech

There is a fixed lighting rig composed of three continuous strip lights that are dimmable. Additionally, there are a number of cold white LED spotlights that are moveable on a track around the space, these are also dimmable.

Onsite power - 4x twin 13A sockets. Wi-Fi is available.

The space includes an air conditioning unit on the ceiling, which is controlled in conjunction with the reception area.

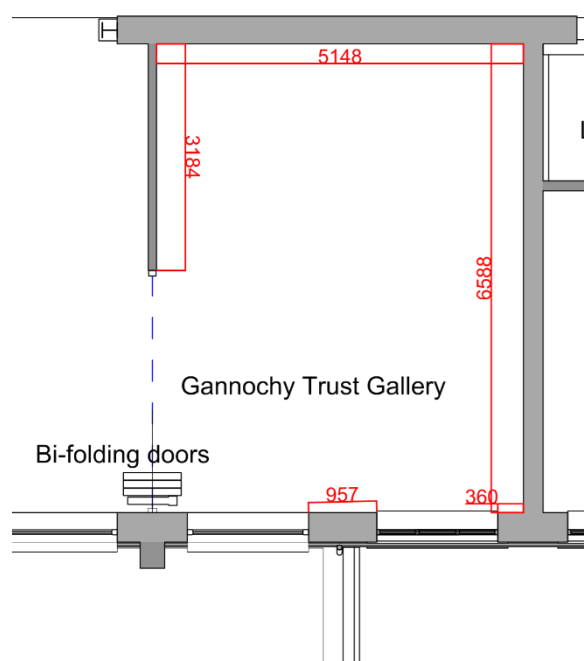

Opening Hours and Invigilation

The building is accessible 24/7 for tenants.

Invigilation, should they require, is coordinated by the artist. However, should cover need to be arranged for whichever reason, then please detail this information in writing to Wasps in advance of the event.

Artists can arrange an evening preview for the event or exhibition. The date and time of all openings will be arranged in advance, but openings usually take place 6-8pm on Friday evenings. The date and time of all openings will be arranged in advance and subject to the standard out of hours staffing costs and conditions. Exhibitors are responsible for supplying refreshments for their exhibition or event opening unless otherwise agreed.

Installation Information

General Health and Safety Information

A risk assessment is required prior to any event taking place in the building. This will then be reviewed by Wasps Property Team.

If you already have liability insurance, a copy of this must also be included if your application is successful.

When vacating the building, please ensure that it is secure, e.g., doors closed/locked and windows closed.

Please familiarise yourself with the Fire Action Procedures to ensure you know how to vacate the building safely in the event of an emergency.

Tools and Equipment

We are unable to loan tools or materials. These must be provided by the artist and covered under the appropriate insurance.

Any electrical products or tools being brought and used on site by the artist must be PAT tested and in date.

The artist is responsible for installing and deinstalling works, which includes returning the gallery to its original condition. Please be mindful of this and ensure you bring the appropriate equipment needed. For example, filler for any drilling done in walls. If this is not done, you may be at risk of losing your booking deposit.

Space Specific Exclusions

The floor is grey vinyl and no drilling or fixing into the floor is permitted.

Who to contact for support

Please contact our Arts and Projects team at projects@waspsstudios.org.uk for any questions or queries regarding your booking. You may also contact Wasps via telephone at 0141 553 5890. To speak directly with the Perth Creative Exchange reception team, you can contact them on 0141 553 5896 (ext. 1017).

Booking Information

Hire costs for The Gannochy Project Space are £250 per week (or a reduced rate of £195 per week for Wasps tenants). Please note that the hires are within regular building opening hours. If you wish to open out with Monday-Friday 9am-5pm then it is subject to a staffing cost of £24 per hour with a minimum call out of 3 hours.

We are happy to consider all manner of projects, exhibitions and events for this space and we welcome projects that are ambitious, innovative, and experimental. The focus of these spaces is to present contemporary visual art and design and crossovers between these art-forms.

All applications will be considered. We ask that you provide us with as much information as possible about your proposed idea (time scale, dates, etc.). Should you have any questions about our application process, please do not hesitate to get in touch. Please email all enquiries to projects@waspsstudios.org.uk

Wasps is able to assist you with limited marketing of your event, as well as selling your work should you choose to. There is a commission fee when selling your work through Wasps. This commission will be discussed and agreed prior to your event.

All successful applicants will be required to sign an artist agreement, that agrees to deliver the proposed project in an outlined timeframe. The artists must state in advance, any talks, workshops or other events that will be linked to the exhibition. The artist is responsible for installing and deinstalling works, which includes returning the gallery to its original condition.

[Apply here](#)