



*Lost Leaves, Alan Campbell, photography by Alexander Hoyles*

# The Briggait – Gallery 1 and 2

141 Bridgegate

Glasgow

G1 5HZ

## Gallery Pack

## An Introduction to the Briggait

The home of Wasps' headquarters, The Briggait is a historic A-listed building housing a multitude of spaces from artist studios, cultural organisation offices, shop units, 2 gallery spaces and the stunning 1873 Market Hall, an impressive architectural space. Reopened in 2009 as a cultural hub by Wasps, the Briggait once was the city's fish market until the 1970's.

## Images of the Space



*Photography by Alexander Hoyles, Above: 'Casual Thread' by Adam Boyd, Below: 'Lost Leaves' by Alan Campbell*



## Accessibility

The Briggait is accessible, except for first floor studios, from the Bridgegate elevation of the building. There are accessible toilets located on the ground floor of the building.

The Briggait is in Glasgow's city centre. We are directly next to the main cycle path that follows the River Clyde. If travelling by train, the Briggait is around a 10 minute walk from Queen Street Station or 5 minutes from Argyle Street Station. From Queen Street walk diagonally across George Square then down Miller Street into Ingram Street. Turn right onto Stockwell Street and keep walking until you see the Briggait on your left-hand side. Alternatively, many bus routes stop on Stockwell Street, two minutes from The Briggait. Car parking is available directly across the road in King Street car park.

## **Features of Gallery 1 and 2**

Located at the main entrance of the Briggait, Galleries 1 and 2 are placed at either side of the building, framing the impressive iron gate front on this A-listed building. The large glass fronts of both galleries allow passers by a 24/7 spectacle of the work on show, whilst letting in beautiful natural light during daytime hours.

The pristine white walls are ideal for any wall-based artwork whether that be prints, paintings, photographs and more. They are spacious galleries with the potential to house 3D work as well as 2D, making them a versatile and popular choice for artists to showcase their work.

There is power available in both galleries and Wi-Fi available on site throughout the Briggait.

## Dimensions

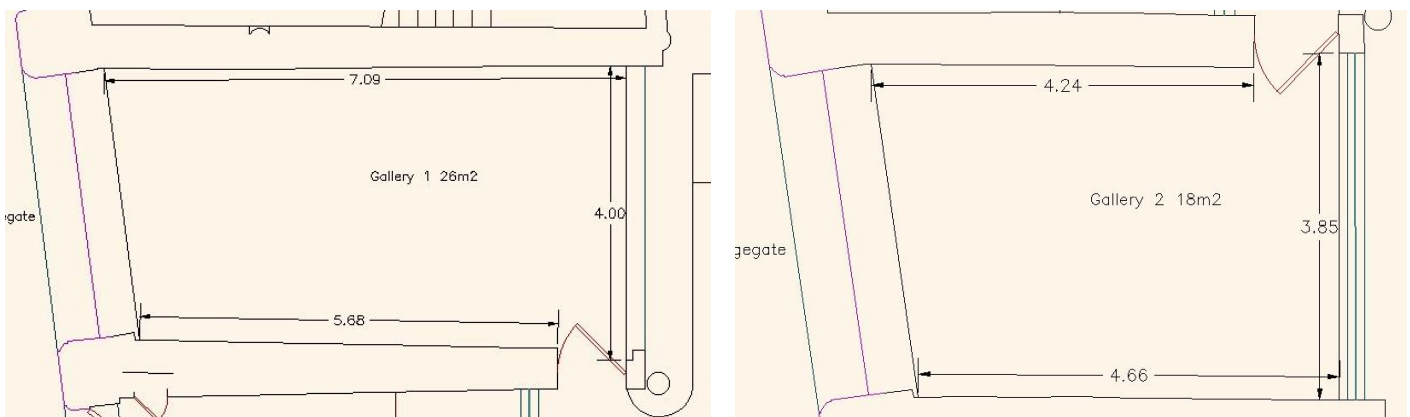

## **Capacity**

Gallery 1 – 20 people

Gallery 2 – 15 people

## **Opening Hours and Invigilation**

The Briggait is open to the public from 9:30am – 5:30pm Monday - Friday and is closed on weekends. Exhibitions may be left unattended, but we remind you that this place is fully accessible to the public during the above opening hours and the building is a working building for tenants who rent our studios. These studios are 24-hour access for Wasps tenants.

Gallery 1 and 2 are locked outside of Wasps opening hours.

For any projects that operate out with the above opening hours, this must be negotiated and discussed in advance in order for Wasps to arrange staffing.

Artists can arrange an evening preview for the event or exhibition. The date and time of all openings will be arranged in advance, but openings usually take place 6-8pm on Friday evenings. The date and time of all openings will be arranged in advance and subject to the standard out of hours staffing costs and conditions. Exhibitors are responsible for supplying refreshments for their exhibition or event opening unless otherwise agreed.

## **Installation Information**

### **General Health and Safety Information**

Prior to any event taking place at the Briggait, a risk assessment must be carried out. This will then be reviewed by our Wasps Property Team.

If you have liability insurance, a copy of this must be provided in the case of all successful applications.

We ask that you familiarise yourself with any Fire Action Procedures ensuring you know how to vacate the building in a safe manner in the event of an emergency.

In the event of a fire please leave the building immediately.

## **Tools and Equipment**

We are unable to loan tools or materials, these must be provided by the artist and covered under the appropriate insurance.

Any electrical products or tools being brought and used on site by the artist must be PAT tested and in date.

The artist is responsible for installing and deinstalling works, which includes returning the gallery to its original condition. Please be mindful of this and ensure you bring the appropriate equipment needed. For example, filler for any drilling done in walls. If this is not done, you may be at risk of losing your booking deposit.

## **Space specific exclusions**

It is not possible to suspend artwork or equipment from the ceiling.

## **Who to contact for support**

Please contact our Arts and Projects team at [projects@waspsstudios.org.uk](mailto:projects@waspsstudios.org.uk) for any questions or queries regarding your booking. You may also contact Wasps via telephone at 0141 553 5890.

## **Booking Information**

Hire costs for The Briggait Galleries 1 & 2 are £300 per week (or a reduced rate of £250 per week for Wasps tenants). Please note that the hires are within regular building opening hours. If you wish to open out with Monday-Friday 9:30am-5:30pm then it is subject to a staffing cost of £24 per hour with a minimum call out of 3 hours.

We are happy to consider all manner of projects, exhibitions and events for this space and we welcome projects that are ambitious, innovative, and experimental. The focus of these spaces is to present contemporary visual art and design and crossovers between these art-forms.

All applications will be considered. We ask that you provide us with as much information as possible about your proposed idea (time scale, dates, etc.). Should you have any questions about our application process, please do not hesitate to get in touch. Please email all enquiries to [projects@waspsstudios.org.uk](mailto:projects@waspsstudios.org.uk)

Wasps is able to assist you with limited marketing of your event, as well as selling your work should you choose to. There is a commission fee when selling your work through Wasps. This commission will be discussed and agreed prior to your event.

All successful applicants will be required to sign an artist agreement, that agrees to deliver the proposed project in an outlined timeframe. The artists must state in advance, any talks, workshops or other events that will be linked to the exhibition. The artist is responsible for installing and deinstalling works, which includes returning the gallery to its original condition.

[Apply here](#)